

THIS DOCUMENT IS THE PROPERTY OF MORGAN TUCKER CONSULTANTS. IT IS TO BE USED ONLY FOR THE PROJECT AND SITE SPECIFICALLY IDENTIFIED HEREIN. IT IS NOT TO BE REPRODUCED, COPIED, OR TRANSMITTED IN ANY FORM OR BY ANY MEANS, ELECTRONIC OR MECHANICAL, INCLUDING PHOTOCOPYING, RECORDING, OR BY ANY INFORMATION STORAGE AND RETRIEVAL SYSTEM, WITHOUT THE WRITTEN PERMISSION OF MORGAN TUCKER CONSULTANTS.

Copyright © Morgan Tucker
 01/10/2015 14:16:00
 CHECKED ON SITE AND REPORT ALL DISCREPANCIES TO REPORT NUMBER

Notes:

- If this drawing has been received electronically it is the recipient's responsibility to print the document to the correct scale.
- This drawing should be read in conjunction with all other relevant drawings and specifications. DISCREPANCIES between the drawings and specifications should be reported to the project manager. If any discrepancy is identified on the drawing and those indicated on other drawings, Morgan Tucker should be informed prior to construction on site.
- All dimensions are in meters unless otherwise stated.
- Unless otherwise stated, all levels are based on the datum shown on the drawing. It should be understood that all drawings issued are preliminary and not for construction.
- All levels to be confirmed on site prior to construction, wherever full horizontal curves & drainage levels survey information and current existing services plans & maps.
- Existing manhole invert levels are to be checked prior to commencing construction.
- All works to be in accordance with the North Yorkshire County Council Specification for Road and Local Authority Roads and Private Street Works second edition.

DATE VALID
 23/12/15

Project: JN1125-NWK-1006
 Sheet: P1

THIS DRAWING IS THE PROPERTY OF MORGAN TUCKER CONSULTANTS LTD. ANY REPRODUCTION OR DISTRIBUTION OF THIS DRAWING WITHOUT THE WRITTEN PERMISSION OF MORGAN TUCKER CONSULTANTS LTD. IS STRICTLY PROHIBITED. THE COPYRIGHT IN THIS DRAWING IS RESERVED BY MORGAN TUCKER CONSULTANTS LTD.

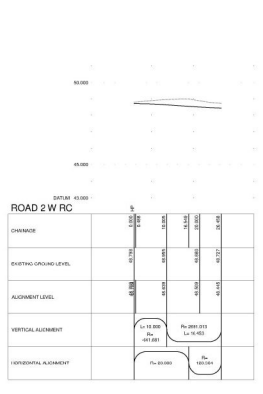
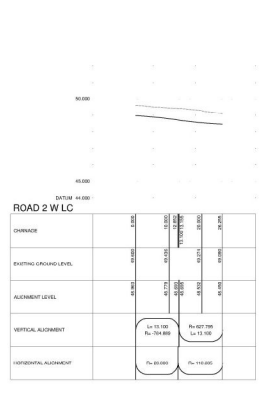
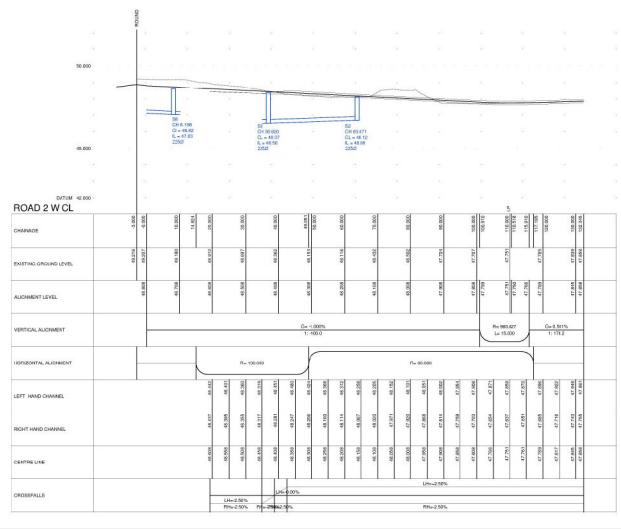
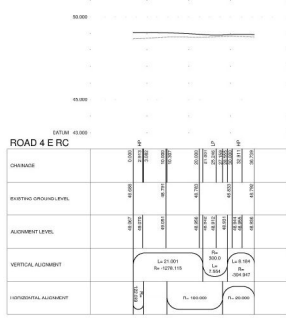
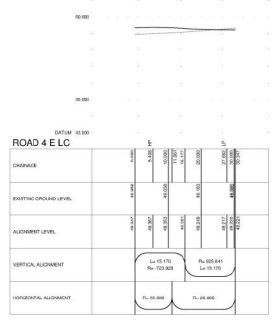

- Copyright © Morgan Tucker
- DO NOT SCALE. DIMENSIONS SHOWN ONLY CHECK ON SITE AND REPORT ALL DISCREPANCIES TO THE DESIGN TEAM.
- If the drawing has been prepared electronically it is the recipient's responsibility to print the document to the correct scale.
 - This drawing should be read in conjunction with all other relevant drawings and specifications. Should there be any conflict between the details included on this drawing and those included on other drawings, Morgan Tucker should be informed prior to construction on site.
 - All dimensions are in meters unless otherwise stated.
 - Until detailed approval has been obtained from the relevant authority, it should be understood that all drawings issued are preliminary and not for construction.
 - All levels to be confirmed on site prior to construction. Existing level topographic survey & drainage levels survey information and current existing ground levels to be checked prior to construction.
 - Existing manhole invert levels are to be checked prior to commencing construction.

No.	Revisions	Date	By

MTmorgan tucker
CONSULTANTS

95 Northcote, Newark, Nottinghamshire, NG24 1HD
Tel: 01636 650100 Fax: 01636 651796
E-Mail: info@morgantucker.co.uk
www.morgantucker.co.uk

Drawn by: Taylor Wintop
Checked by: Development of Brighton Road
Barton
North Yorkshire

Project: Long Sledmere
Sheet: 2 of 4
(Sheet 2 of 4)

Date: November 2015
Scale: As Shown
Project No: 15002-01-100

Author: JN1125-NWK-1007

DATE VALID 23/12/15

P1

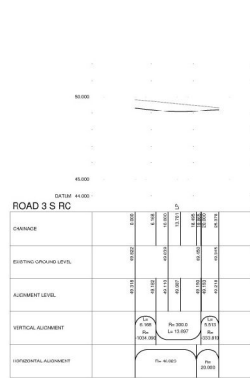
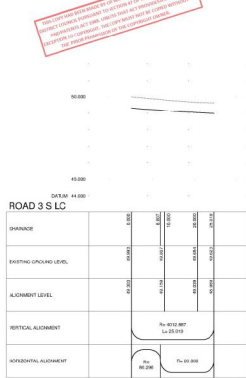
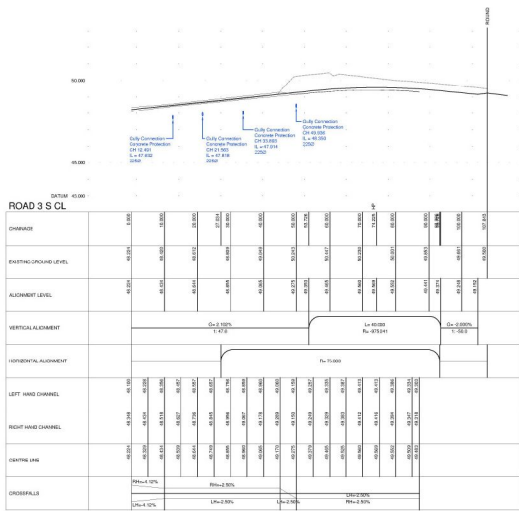
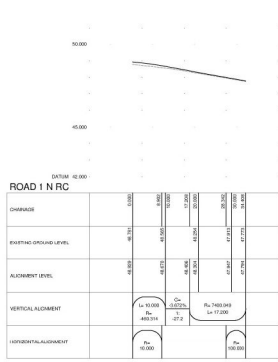
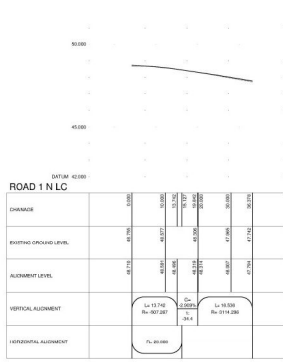
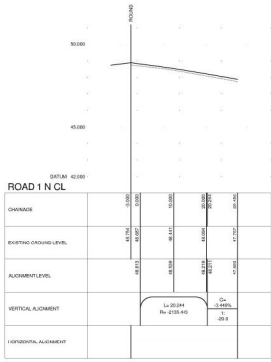

THIS DRAWING IS THE PROPERTY OF MT MORGAN LUCKER CONSULTING ENGINEERS. IT IS TO BE USED ONLY FOR THE PROJECT AND SITE SPECIFICALLY IDENTIFIED HEREIN. IT IS NOT TO BE REPRODUCED, COPIED, OR TRANSMITTED IN ANY FORM OR BY ANY MEANS, ELECTRONIC OR MECHANICAL, INCLUDING PHOTOCOPYING, RECORDING, OR BY ANY INFORMATION STORAGE AND RETRIEVAL SYSTEM, WITHOUT THE WRITTEN PERMISSION OF MT MORGAN LUCKER CONSULTING ENGINEERS.

- Copyright © Morgan Tucker
- DO NOT SCALE. ALL DIMENSIONS AND LEVELS CHECK ON SITE AND REPORT ALL DISCREPANCIES TO THE SURVEYOR.
- Notes:
- If this drawing has been received electronically a 24-hour revision period is available to permit the client to amend the drawing.
 - This drawing should be read in conjunction with all other relevant drawings and specifications. Should there be any conflict between the details indicated on this drawing and those indicated on other drawings, Morgan Tucker must be notified prior to construction on site.
 - All dimensions are in meters unless otherwise stated.
 - Unless technical approval has been obtained from the relevant authority, it should be considered that all drawings issued are preliminary and not for construction.
 - All levels to be confirmed on site prior to construction, following full topographical survey & drainage levels survey information and current existing drainage plans & maps.
 - Existing manhole invert levels are to be checked prior to commencing construction.
 - All works to be in accordance with the North Yorkshire County Council Specification for Highway and Local Road Works and Private Street Works General Submittal.

No.	Revision	Date	By

MTmorgan tucker
CONSULTING ENGINEERS

95 Northcote, Newark, Nottinghamshire, NG24 1HD
Tel: 01636 670 340 Fax: 01636 670 796
E-Mail: info@morgantucker.co.uk
www.morgantucker.co.uk

Prepared by: Taylor Wintop

Checked by: Development of Broughton Road
Barnby
North Yorkshire

Project: Long Sledmire
Sheet: 1 of 4
(Check: 1 of 2)

Date: November 2015
Scale: As Shown
Revision: 1 of 1

Project: Barnby

Drawn: JN1125-NWK-1008

DATE VALID 23/12/15

THIS DRAWING HAS BEEN PREPARED BY THE CONSULTANT AND IS FOR INFORMATION ONLY. IT IS NOT TO BE USED FOR CONSTRUCTION OR AS EVIDENCE IN ANY COURT OF LAW. THE CONSULTANT ACCEPTS NO LIABILITY FOR ANY DAMAGE OR LOSS OF PROFITS, REVENUE OR PROFITS, WHICH MAY BE INCURRED BY ANY PERSON OR ENTITY, IN RELIANCE ON THIS DRAWING, WHETHER OR NOT SUCH DAMAGE OR LOSS OF PROFITS, REVENUE OR PROFITS, IS FORESEEABLE. THE CONSULTANT'S LIABILITY IS LIMITED TO THE AMOUNT OF FEES PAID TO THE CONSULTANT.

DATUM 43.000
ROUNDABOT

CHAINAGE	C.000	
EXISTING GROUND LEVEL	48.870	48.870
ALIGNMENT LEVEL	48.832	48.832
VERTICAL ALIGNMENT	Cx=1.180% 1.54.0	
HORIZONTAL ALIGNMENT	R=17.000 L=20.000 R=448.338 Cx=-1.180% 1.44.0	
LEFT HAND CHANNEL	48.967	48.967
RIGHT HAND CHANNEL	48.892	48.892
CENTRE LINE	48.915	48.915
CROSSFALLS	LH=-2.50% RH=2.50%	

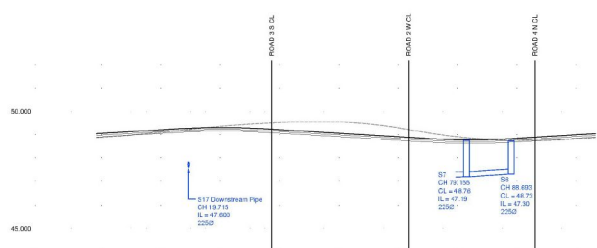

Copyright © Morgan Tuckler
 DO NOT SCALE. USE FIGURES DIMENSIONS ONLY.
 CHECK ON SITE AND REPORT ALL DISCREPANCIES TO
 MORGAN TUCKLER.

- Notes:
1. If this drawing has been received electronically it is the recipient's responsibility to print the document to the correct scale.
 2. This drawing should be read in conjunction with all other relevant drawings and specifications. Should there be any conflict between the details indicated on this drawing and those indicated on other drawings Morgan Tuckler should be informed prior to construction on site.
 3. All dimensions are in meters unless otherwise stated.
 4. Unless technical approval has been obtained from the relevant authority, it should be understood that all drawings issued are preliminary and not for construction.
 5. All levels to be confirmed on site prior to construction following full topographical survey & drainage levels survey information and current existing services plans & maps.
 6. Existing manhole invert levels are to be checked prior to commencing construction.
 7. All works to be in accordance with the North Yorkshire County Council Specification for Housing and Industrial Estate Roads and Private Street Works Second edition.

Rev	Amendment	Date	By

MT morgan tuckler
 consulting engineers

65 Northgate, Newark, Nottinghamshire, NG24 1HD
 Tel: 01636 310 766 Fax: 01636 610 766
 E Mail: info@morgantuckler.co.uk
 www.morgantuckler.co.uk

Client: Taylor Wimpey

Project: Development off Broughton Road
 Metton
 North Yorkshire

Drawings: Long Sections
 Sheet 4 of 4
 (Roundabout)

Client	Drawn By	Checked By	Approved By

Date: November 2015
 Scale: 1:500
 Project: Freshwary
 Drawing: JN1425-JWK-1009
 Page: P1

DATE VALID
 23/12/15

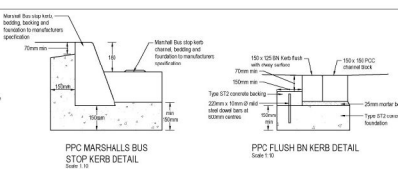
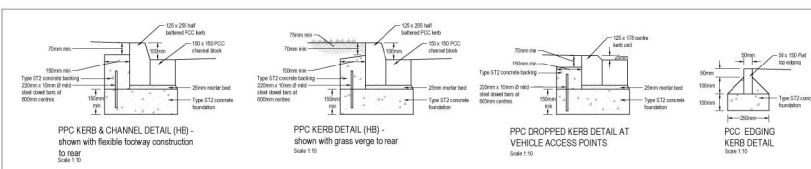

- Note**
- If this drawing has been received electronically in the respective responsibility to the contractor to be confirmed to the contractor.
 - The drawing should be read in conjunction with all other relevant drawings and specifications. Check there are no conflicts between the details shown on this drawing and those indicated on other drawings Morgan Tuckey should be contacted if a conflict is identified.
 - All dimensions are in millimetres unless otherwise stated.
 - Call Morgan Tuckey for more details on the specification of the relevant authority. It should be understood that all drawings are the property of Morgan Tuckey and are not to be reproduced without the written permission of Morgan Tuckey. Any reproduction or use of any drawings, text or information on any other drawing, plans & sheets.

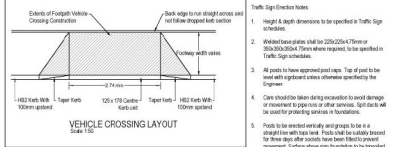
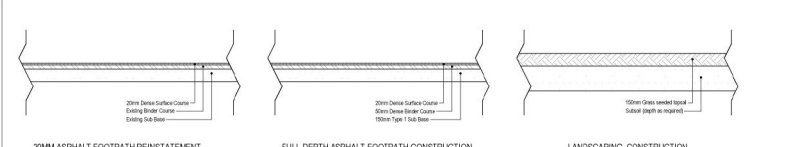

- Traffic Sign Direction Notes**
- Height & depth dimensions to be specified in Traffic Sign instructions.
 - Waterfall base plates shall be 225x225mm (Square) or 400x300mm (Rect) when required. Size specified in Traffic Sign instructions.
 - All posts to be approved post. Top of sign face level with top of base unless otherwise specified by the sign.
 - Care should be taken during excavation to avoid damage to services or other utilities. Sign posts will be installed in accordance with the instructions.
 - Posts to be erected vertically and upright to be a straight line with level. Posts that are not upright for three days after erection have been erected in error. Erection of sign posts should be inspected and approved by the contractor to be in the location of the surrounding roadway.
 - A clearance of at least 600mm between the sign face and the protruding edge of the sign shall be provided. Signs to be erected at an angle of 0° away from the kerb line to meet compliance.
 - Service door on illuminated signs shall be facing away from the carriageway where possible (see BS 5720:2009) unless otherwise specified in the sign instructions.

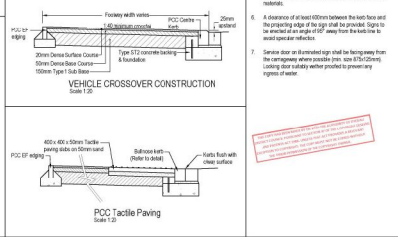
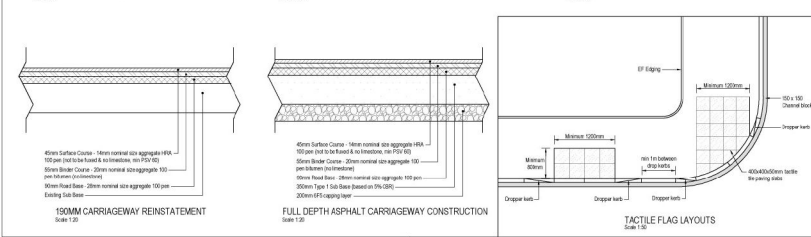

- Where a company's longitudinal gradient is flatter than 1 in 100, the sign should be erected on a raised platform.
- Where signs are erected on a raised platform, the kerb height should be 150mm and the platform should be 150mm wide.
- The concrete base should be constructed to BS 5720:2009.
- Clearance should be provided to allow a 2000 x 1500mm sign to be erected on the sign.
- Posts, channels and edging shall be hydraulically pressed concrete BS 5720:2009 and shall be installed in a straight line with level. Posts that are not upright for three days after erection have been erected in error. Erection of sign posts should be inspected and approved by the contractor to be in the location of the surrounding roadway.
- Edging shall be hydraulically pressed concrete BS 5720:2009 and shall be installed in a straight line with level. Edging that is not upright for three days after erection have been erected in error. Erection of sign posts should be inspected and approved by the contractor to be in the location of the surrounding roadway.

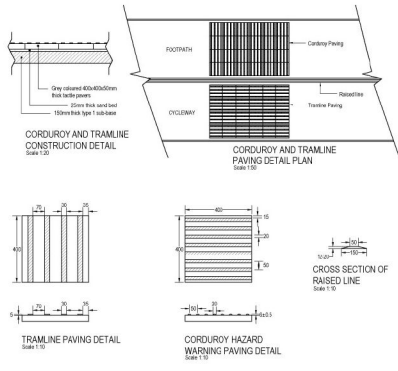
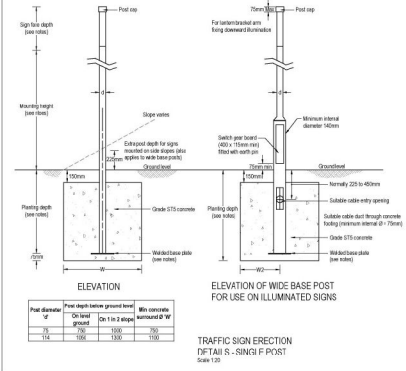

Post section		Concrete foundation		Post section		Post depth below ground	
Concrete diameter	Thickness	Length (mm)	Level	1 to 2 steps	Diameter (mm)	Standard depth (mm)	Post depth below ground (mm)
75	43	1000	400	1000	275	750	1000
114	43	1300	400	1300	275	750	1300
146	44	1600	400	1600	300	800	1600
188	44	1900	400	1900	325	850	1900
229	49	2200	400	2200	350	900	2200
279	53	2500	400	2500	375	950	2500

TRAFFIC SIGN ERECTION DETAILS - DOUBLE POST
 Scale 1:40

TRAFFIC SIGN ERECTION DETAILS - DOUBLE POST
 Scale 1:40

- Where a company's longitudinal gradient is flatter than 1 in 100, the sign should be erected on a raised platform.
 - Where signs are erected on a raised platform, the kerb height should be 150mm and the platform should be 150mm wide.
 - The concrete base should be constructed to BS 5720:2009.
 - Clearance should be provided to allow a 2000 x 1500mm sign to be erected on the sign.
 - Posts, channels and edging shall be hydraulically pressed concrete BS 5720:2009 and shall be installed in a straight line with level. Posts that are not upright for three days after erection have been erected in error. Erection of sign posts should be inspected and approved by the contractor to be in the location of the surrounding roadway.
 - Edging shall be hydraulically pressed concrete BS 5720:2009 and shall be installed in a straight line with level. Edging that is not upright for three days after erection have been erected in error. Erection of sign posts should be inspected and approved by the contractor to be in the location of the surrounding roadway.
- DATE VALID 23/12/15**
- JN1125-NW-1013**

MTmorgan tuckey
 CONSULTING ENGINEERS

65 Northgate, Newark, Nottinghamshire, NG24 1HD
 Tel: 01636 610 700 Fax: 01636 610 706
 E-Mail: info@morgantuckey.co.uk
 www.morgantuckey.co.uk

Project: Development Off Broughton Road, North Yorkshires
 Highway Construction Details

Scale: 1:20, 1:40, 1:10
 Date: 23/12/15
 Drawing No: JN1125-NW-1013

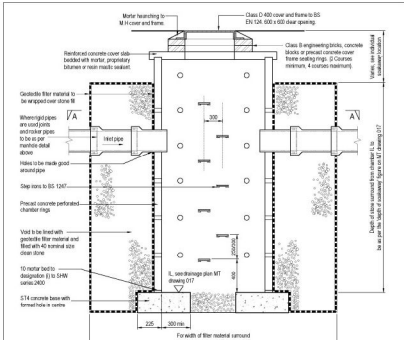

PRECAST CONCRETE RING SOAKAWAY DETAIL Scale 1:20

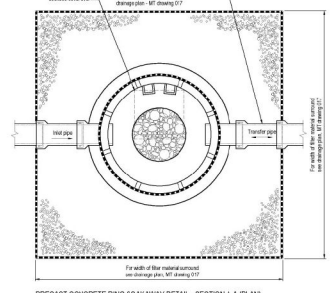

PRECAST CONCRETE RING SOAKAWAY DETAIL - SECTION A-A (PLAN) Scale 1:20

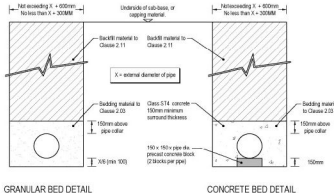

GRANULAR BED DETAIL Scale 1:20

CONCRETE BED DETAIL Scale 1:20

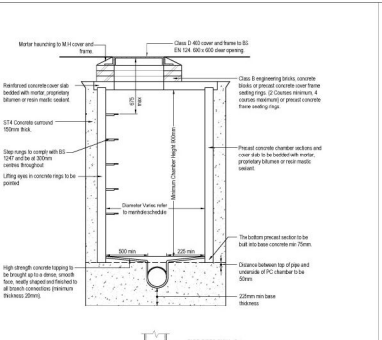

TYPE E MANHOLE DETAIL Scale 1:20

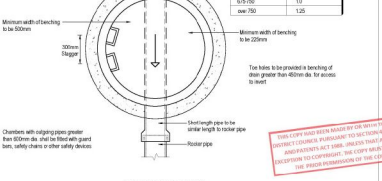

TYPE E MANHOLE DETAIL - SECTION A-A (PLAN) Scale 1:20

ROD PIPE ONLY - See Main Notes for rod pipe	ROD PIPE ONLY - See Main Notes for rod pipe
150mm dia	150mm dia
100mm dia	100mm dia
75mm dia	75mm dia
50mm dia	50mm dia

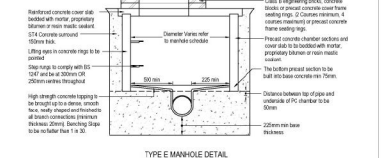

TYPE E MANHOLE DETAIL Scale 1:20

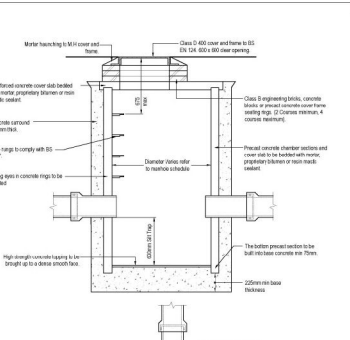

SLT TRAP DETAIL MANHOLE DETAIL Scale 1:20

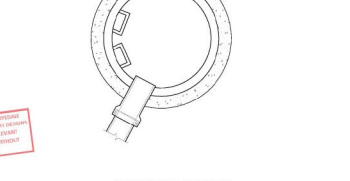

CROSS SECTION THROUGH PCC ROAD GULLY Scale 1:20

Copyright © Morgan Tuckor

1. This drawing has been produced electronically from the original drawings and is not to be used for construction purposes.
2. The drawing should be used in conjunction with other relevant drawings and specifications. It should be used in conjunction with the relevant specifications and standards.
3. All dimensions are in millimetres unless otherwise stated.
4. Use of this drawing is subject to the terms and conditions of the Morgan Tuckor Terms and Conditions of Sale.
5. All levels to be confirmed on site prior to construction. Allowance for topographical survey is to be made.
6. It is the contractor's responsibility to determine the location and depth of any existing services and to protect them.
7. All works to be in accordance with the British Standards Code of Practice for the installation of drainage systems and the relevant specifications and standards.
8. The contractor shall be responsible for the provision of all necessary materials and labour for the installation of the drainage system.
9. The contractor shall be responsible for the provision of all necessary materials and labour for the installation of the drainage system.
10. The contractor shall be responsible for the provision of all necessary materials and labour for the installation of the drainage system.

DATE VALID 2012/12/15

MTmorgan tuckor
CONSULTING ENGINEERS

15 Victoria Road, Northampton, Northamptonshire, NN2 4HD
Tel: 01603 610100 Fax: 01603 610199
E-Mail: info@morgantuckor.co.uk
www.morgantuckor.co.uk

Project: Development of Drainage Plans
Location: Northampton

Author: Taylor Wintour

Checked: Development of Drainage Plans
Checked: Northampton

Scale: Drainage Details

Sheet: 1 of 1

File: J01125-NW-1014

Page: P1

